

Residential Property Record Card

Date Printed 09/01/20

<p align="center">Owner Information</p> <p>Parcel 0500093 Owner QUELCH ELITA 41 POST ROAD RUTLAND, VT 05701 Location 0 JENNA LANE Descr: LAND</p>	<p align="center">Parcel Value Information</p> <p>Land Value 21,700 Homestead 0 Dwelling Value 0 Housesite 0 Site Imprvmt 0 Outbuildings 0 Misc. Adj. 0 Total 21,700</p>	<div style="border: 1px solid black; width: 100%; height: 100%; text-align: center;">  </div> <p align="right">Sketch Updated: / /</p>
<p align="center">Parcel Information</p> <p>Tax Map # NBHD 3 Span 345-107-10811 Acres 13.25 Status A - Active Last Update 04/14/20</p>		
<p align="center">Sales Information</p> <p>Book Sale Date / / Page Sale Price 0</p>		

BUILDING	Total Rooms	0	Year Built	0	Building SF	0	Energy Adj	No Data	Roughins	0
	Bedrooms	0	Effect Age	0.0	Quality	0.00	Bsmt Wall	NoData	Plumb Fixt	0
	Full Baths	0	Condition	No Data	Style	No Data	Bsmt SF	0.00	Fireplaces	0
	Half Baths	0	Phys Depr	0	Design	No Data	Bsmt Fin	No Data	Porch	0
	Kitchens	0	Funct Depr	0	Bldg Type	No Data	Bsmt Fin SF	0	Gar/Shed	0
		Econ Depr	0					% Complete:	0	

INSPECT	INSP.	NoData	INSP.	NoData	INSP.	NoData	APPT	NoData	APPTSCHD
----------------	-------	--------	-------	--------	-------	--------	------	--------	----------

NOTES

Residential Property Record Card

Date Printed 09/01/20

Owner Information
 Parcel 050013
 Owner QUELCH JOHN K
 138 JENNA LANE
 WHITING, VT 05778
 Location 138 JENNA LANE
 Descr: LAND & MOBILE HOME

Parcel Value Information
 Land Value 36,500 Homestead 128,500
 Dwelling Value 72,700 Housesite 128,500
 Site Imprvmt 15,000
 Outbuildings 4,300
 Misc. Adj. 0
 Total 128,500

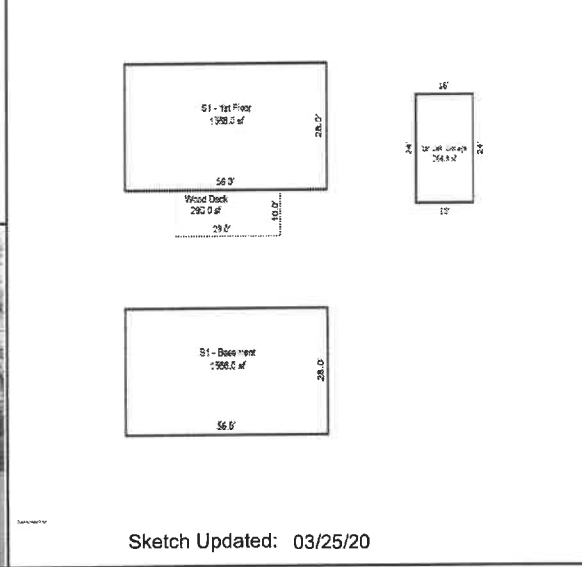

Parcel Information
 Tax Map # NBHD 10
 Span 345-107-10575 Acres 1.10
 Status A - Active Last Update 03/25/20

Sales Information
 Book 83 Sale Date 11/08/19
 Page 278-279 Sale Price 0

BUILDING	Total Rooms	5	Year Built	2000	Building SF	1568	Energy Adj	Average	Roughins	1
	Bedrooms	3	Effect Age	20.0	Quality	3.50	Bsmt Wall	Conc 8"	Plumb Fixt	8
	Full Baths	2	Condition	Average	Style	1 Story	Bsmt SF	1568.00	Fireplaces	0
	Half Baths	0	Phys Depr	40	Design	DblWide	Bsmt Fin	UnFinsh	Porch	290
	Kitchens	1	Funct Depr	0	Bldg Type	Mobile	Bsmt Fin SF	0	Gar/Shed	0
			Econ Depr	0					% Complete:	0

INSPECT	INSP.	NoData	INSP.	NoData	INSP.	NoData	APPT	NoData	APPTSCHD
----------------	-------	--------	-------	--------	-------	--------	------	--------	----------

NOTES

Residential Property Record Card

Date Printed 02/13/24

Owner Information
 Parcel 222005
 Owner QUENNEVILLE CLAUDE M &
 18 HOOKER RD
 LEICESTER, VT 05733
 Location 18 HOOKER RD
 Descr: LAND & DWELLING

Parcel Information
 Tax Map # NBHD 5
 Span 345-107-10578 Acres 3.54
 Status A - Active Last Update 03/10/21

Sales Information
 Book 00036 Sale Date / /
 Page 00215 Sale Price 0

Parcel Value Information
 Land Value 55,400 Homestead 211,000
 Dwelling Value 99,200 Housesite 205,600
 Site Imprvmt 15,000
 Outbuildings 41,400
 Misc. Adj. 0
 Total 211,000

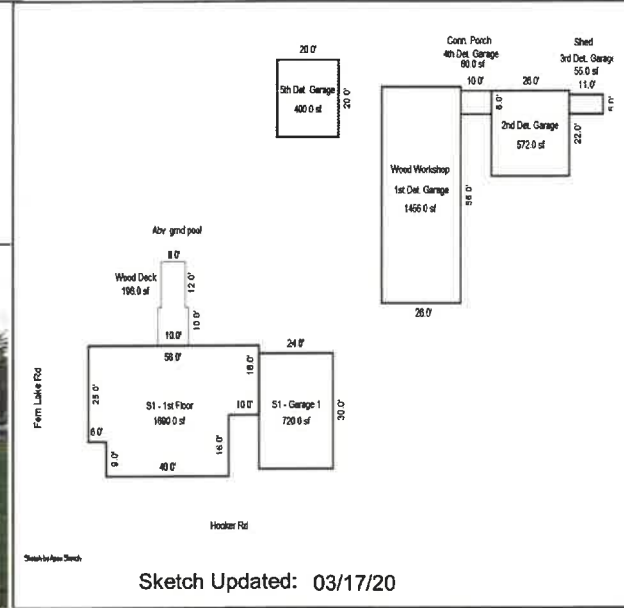

BUILDING	Total Rooms	6	Year Built	1850	Building SF	1690	Energy Adj	Average	Roughins	1
	Bedrooms	3	Effect Age	70.0	Quality	2.75	Bsmt Wall	NoData	Plumb Fixt	8
	Full Baths	2	Condition	Average	Style	1 Story	Bsmt SF	0.00	Fireplaces	0
	Half Baths	0	Phys Depr	40	Design	One Story	Bsmt Fin	No Data	Porch	196
	Kitchens	1	Funct Depr	0	Bldg Type	Single	Bsmt Fin SF	0	Gar/Shed	720
			Econ Depr	0					% Complete:	0

INSPECT	INSP.	NoData	INSP.	NoData	INSP.	NoData	APPT	NoData	APPTSCHD
----------------	-------	--------	-------	--------	-------	--------	------	--------	----------

NOTES
 DWL & LAND CORNER OF FERN LAKE RD& HOOKER RD:

Residential Property Record Card

Date Printed 05/02/23

<p align="center">Owner Information</p> <p>Parcel 020025211 Owner QUENNEVILLE CORY J & JESSICA M 31 PALMER ROAD CHESTER, VT 05143-9717 Location 0 US RT 7 Descr: LAND</p>	<p align="center">Parcel Value Information</p> <p>Land Value 85,400 Homestead 0 Dwelling Value 0 Housesite 0 Site Imprvmt 0 Outbuildings 0 Misc. Adj. 0 Total 85,400</p>	
<p align="center">Parcel Information</p> <p>Tax Map # NBHD 7 Span 345-107-10875 Acres 16.10 Status A - Active Last Update 03/21/23</p>		
<p align="center">Sales Information</p> <p>Book Sale Date / / Page Sale Price 0</p>		<p align="right">Sketch Updated: / /</p>

BUILDING	Total Rooms	0	Year Built	0	Building SF	0	Energy Adj	No Data	Roughins	0
	Bedrooms	0	Effect Age	0.0	Quality	0.00	Bsmt Wall	NoData	Plumb Fixt	0
	Full Baths	0	Condition	No Data	Style	No Data	Bsmt SF	0.00	Fireplaces	0
	Half Baths	0	Phys Depr	0	Design	No Data	Bsmt Fin	No Data	Porch	0
	Kitchens	0	Funct Depr	0	Bldg Type	No Data	Bsmt Fin SF	0	Gar/Shed	0
			Econ Depr	0			% Complete:	0		

INSPECT	INSP.	NoData	INSP.	NoData	INSP.	NoData	APPT	NoData	APPTSCHD
----------------	-------	--------	-------	--------	-------	--------	------	--------	----------

NOTES 2023 new parcel retained only 106.1 ac from 02002521

Residential Property Record Card

Date Printed 11/21/23

Owner Information
 Parcel 02002522
 Owner QUENNEVILLE CORY J & JESSICA M
 31 PALMER RD
 CHESTER, VT 05143
 Location 0 US RT 7
 Descr: LAND

Parcel Value Information
 Land Value 84,900 Homestead 0
 Dwelling Value 0 Housesite 0
 Site Imprmnt 0
 Outbuildings 0
 Misc. Adj. 0
 Total 84,900

Parcel Information
 Tax Map # NBHD 7
 Span 345-107-10873 Acres 16.10
 Status A - Active Last Update 08/17/23

Sales Information
 Book 88 Sale Date 06/16/22
 Page 078-080 Sale Price 0

Sketch Updated: / /

BUILDING	Total Rooms	0	Year Built	0	Building SF	0	Energy Adj	No Data	Roughins	0
	Bedrooms	0	Effect Age	0.0	Quality	0.00	Bsmt Wall	NoData	Plumb Fixt	0
	Full Baths	0	Condition	No Data	Style	No Data	Bsmt SF	0.00	Fireplaces	0
	Half Baths	0	Phys Depr	0	Design	No Data	Bsmt Fin	No Data	Porch	0
	Kitchens	0	Funct Depr	0	Bldg Type	No Data	Bsmt Fin SF	0	Gar/Shed	0
			Econ Depr	0					% Complete:	0

INSPECT	INSP.	NoData	INSP.	NoData	INSP.	NoData	APPT	NoData	APPTSCHD
----------------	-------	--------	-------	--------	-------	--------	------	--------	----------

NOTES
 2023
 rertained 15.741 ac following transfer of 0200252 with only 5.9 ac and dwelling

Residential Property Record Card

Date Printed 09/01/20

Owner Information
 Parcel 020025
 Owner QUENNEVILLE LILLIAN TRUST
 2124 US RT 7
 LEICESTER, VT 05733
 Location 2124 US RT 7
 Descr: LAND & DWELLING

Parcel Value Information
 Land Value 87,100 Homestead 304,200
 Dwelling Value 202,100 Housesite 257,600
 Site Imprvmt 15,000
 Outbuildings 0
 Misc. Adj. 0
 Total 304,200

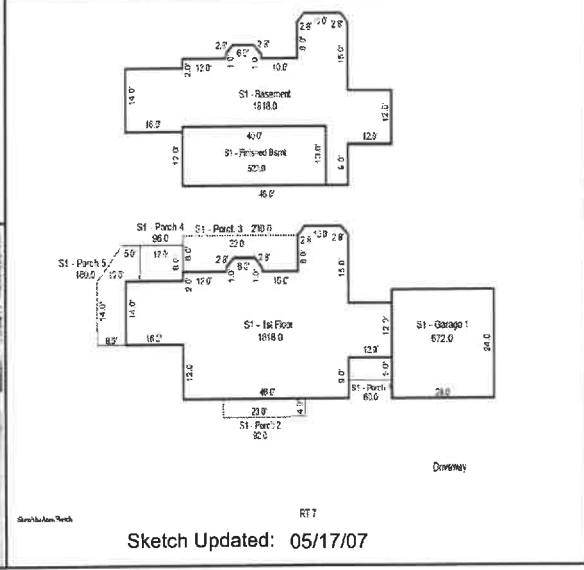

Parcel Information
 Tax Map # NBHD 7
 Span 345-107-10579 Acres 34.00
 Status A - Active Last Update 08/11/20

Sales Information
 Book 73 Sale Date 12/28/12
 Page 6 Sale Price 0

BUILDING	Total Rooms	6	Year Built	1993	Building SF	1818	Energy Adj	Average	Roughins	1
	Bedrooms	3	Effect Age	19.0	Quality	2.75	Bsmt Wall	Conc 8"	Plumb Fixt	11
	Full Baths	2	Condition	Average	Style	1 Story	Bsmt SF	1818.00	Fireplaces	1
	Half Baths	0	Phys Depr	17	Design	Ranch	Bsmt Fin	Rec	Porch	658
	Kitchens	1	Funct Depr	0	Bldg Type	Single	Bsmt Fin SF	520	Gar/Shed	672
			Econ Depr	0					% Complete:	100

INSPECT	INSP.	NoData	INSP.	NoData	INSP.	NoData	APPT	NoData	APPTSCHD
----------------	-------	--------	-------	--------	-------	--------	------	--------	----------

NOTES
 DWL AND LAND OFF RTE 7:

Residential Property Record Card

Date Printed 02/13/24

Owner Information
 Parcel 0200251
 Owner QUENNEVILLE MATTHEW R & ERICA
 2664 ROUTE 7
 LEICESTER, VT 05733
 Location 2664 US RT 7
 Descr: LAND & DWELLING

Parcel Value Information
 Land Value 83,300 Homestead 220,600
 Dwelling Value 122,300 Housesite 177,800
 Site Imprmnt 15,000
 Outbuildings 0
 Misc. Adj. 0
 Total 220,600

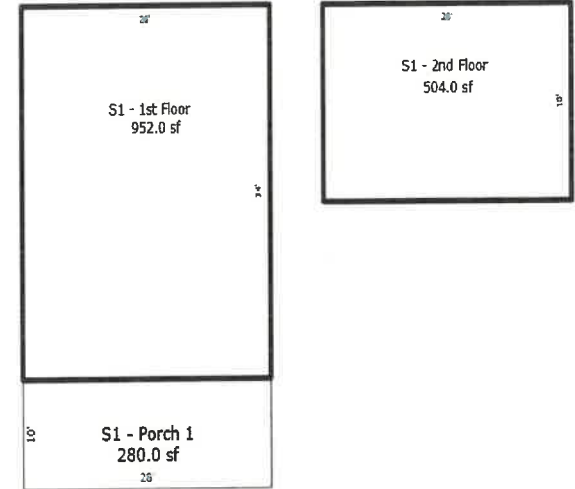

Sketch Updated: 06/14/23

Parcel Information
 Tax Map # 020025.1 NBHD 7
 Span 345-107-10863 Acres 30.30
 Status A - Active Last Update 06/27/23

Sales Information
 Book 82 Sale Date 04/09/19
 Page 312 Sale Price 15,000

BUILDING	Total Rooms	8	Year Built	2020	Building SF	1456	Energy Adj	Good	Roughins	1
	Bedrooms	2	Effect Age	0.0	Quality	3.00	Bsmt Wall	Conc 8"	Plumb Fixt	7
	Full Baths	1	Condition	Average	Style	2 Story	Bsmt SF	952.00	Fireplaces	0
	Half Baths	1	Phys Depr	0	Design	Two Story	Bsmt Fin	No Data	Porch	280
	Kitchens	1	Funct Depr	0	Bldg Type	Single	Bsmt Fin SF	0	Gar/Shed	0
			Econ Depr	0					% Complete:	80

INSPECT	INSP.	Reschedu	INSP.	Other	INSP.	Permit	APPT	NoData	APPTSCHD
----------------	-------	----------	-------	-------	-------	--------	------	--------	----------

NOTES
 2023-still incomplete
 2022
 LT made 80% complete, added porch recheck for cathedral area
 2022-JZ- NOT SURE IF THIS RECORD IS CORRECT- THE HOME AT 2642 IS NOT THE ONE SHOWN HERE

Residential Property Record Card

Date Printed 09/01/20

Owner Information
 Parcel 0200252
 Owner QUENNEVILLE MAURICE
 1870 SHARD VILLA RD
 SALISBURY, VT 05769
 Location 0 US RT 7
 Descr: LAND

Parcel Value Information
 Land Value 86,600 Homestead 0
 Dwelling Value 0 Housesite 0
 Site Imprvmt 0
 Outbuildings 0
 Misc. Adj. 0
 Total 86,600



Parcel Information
 Tax Map # NBHD 7
 Span 345-107-10580 Acres 110.19
 Status A - Active Last Update 03/14/18

Sales Information
 Book 80 Sale Date 11/13/17
 Page 553-555 Sale Price 15,000

Sketch Updated: / /

BUILDING	Total Rooms	0	Year Built	0	Building SF	0	Energy Adj	No Data	Roughins	0
	Bedrooms	0	Effect Age	0.0	Quality	0.00	Bsmt Wall	NoData	Plumb Fixt	0
	Full Baths	0	Condition	No Data	Style	No Data	Bsmt SF	0.00	Fireplaces	0
	Half Baths	0	Phys Depr	0	Design	No Data	Bsmt Fin	No Data	Porch	0
	Kitchens	0	Funct Depr	0	Bldg Type	No Data	Bsmt Fin SF	0	Gar/Shed	0
			Econ Depr	0					% Complete:	0

INSPECT	INSP.	NoData	INSP.	NoData	INSP.	NoData	APPT	NoData	APPTSCHD
----------------	-------	--------	-------	--------	-------	--------	------	--------	----------

NOTES
 PTR RECEIVED TRANSFERRING 22 ACRES FROM MAURICE QUENNEVILLE TO CORY AND JESSICA QUENNEVILLE EFF 11/13/17 SALE PRICE \$15,000.00 FAMILY SALE. TOTAL ACREAGE AFTER TRANSFER IS 140.49. TAG

Residential Property Record Card

Date Printed 09/01/20

Owner Information
 Parcel 222115
 Owner QUINLAN JACK & GERALDINE
 5146 E LANDIS AVE
 E VINELAND, NJ 08360
 Location 321 WESTSIDE DR
 Descr: LAND & CAMP

Parcel Value Information
 Land Value 162,000 Homestead 271,500
 Dwelling Value 94,500 Housesite 271,500
 Site Imprvmt 15,000
 Outbuildings 0
 Misc. Adj. 0
 Total 271,500

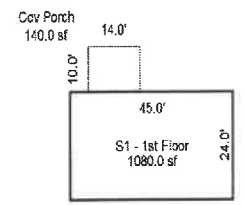

Parcel Information
 Tax Map # NBHD 12
 Span 345-107-10585 Acres 0.71
 Status A - Active Last Update 03/18/20

Sales Information
 Book 00040 Sale Date / /
 Page 00423 Sale Price 0

Sketch Updated: 10/06/11

BUILDING	Total Rooms	4	Year Built	1990	Building SF	1080	Energy Adj	Average	Roughins	0
	Bedrooms	2	Effect Age	30.0	Quality	5.00	Bsmt Wall	NoData	Plumb Fixt	5
	Full Baths	1	Condition	Avg/Good	Style	1 Story	Bsmt SF	0.00	Fireplaces	1
	Half Baths	0	Phys Depr	22	Design	Ranch	Bsmt Fin	No Data	Porch	140
	Kitchens	1	Funct Depr	0	Bldg Type	Camp	Bsmt Fin SF	0	Gar/Shed	0
			Econ Depr	0					% Complete:	0

INSPECT	INSP.	NoData	INSP.	NoData	INSP.	NoData	APPT	NoData	APPTSCHD
----------------	-------	--------	-------	--------	-------	--------	------	--------	----------

NOTES
 somewhat steep to lake
 no interior inspection
 appears to be typical ranch, old card indicates tile floors and sheetrock interior